

10B

Section 10

← N

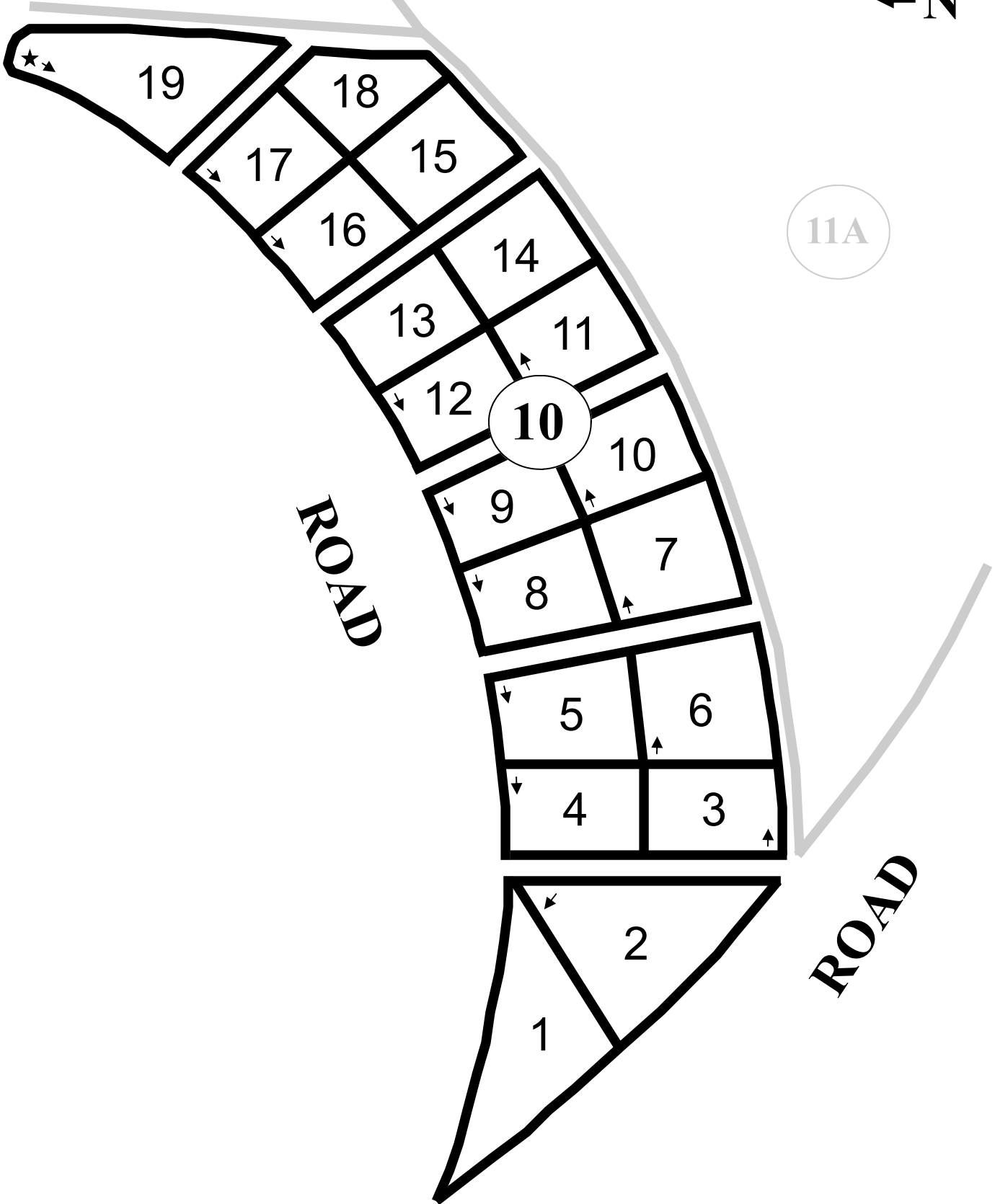

11A

- ★ Start of Section transcription
- ➔ Start and direction of Lot transcription

Section 10
Family Lots

	FAMILY	ACQUIRED BY	DATE
Lot 1	n/a	n/a	n/a
Lot 2 North	Palmer	n/a	n/a
Lot 2 South	n/a	n/a	n/a
Lot 3	various	n/a	n/a
Lot 4	Avey	n/a	n/a
Lot 5	Grinnell	n/a	n/a
Lot 6	Neil	n/a	n/a
Lot 7 East	LaPearl	n/a	n/a
Lot 7 West	Culp	n/a	n
Lot 8 East	Schrader	n/a	n/a
Lot 8 West	Saley	n/a	n/a
Lot 9	Watts	n/a	n/a
Lot 10	Hinman	Chas N. Hinman	Nov. 29, 1922
Lot 11	Sessions	n/a	n/a
Lot 12	Brown	n/a	n/a
Lot 13	n/a	n/a	n/a
Lot 14	n/a	n/a	n/a
Lot 15	n/a	n/a	n/a
Lot 16	Hall	n/a	n/a
Lot 17	Moe	n/a	n/a
Lot 18	n/a	n/a	n/a
Lot 19	Sackett	Anna Meisner	Apr. 25, 1922 ¹

¹ reassigned to R. H. Sackett on Sept. 9, 1925; Anna Meisner and husband are now in the Mausoleum

Section 10

Lot 19

Row 1

DELAIRE	Charles E.	1879 - 1926 (d. Nov. 6, <u>1925</u> in Northville)
MOGGE	Florence SACKETT	"Daughter", 1906 - 1942 (d. Jan. 31, 1942 in Detroit)
SACKETT	Myrtle Maude GARFIELD	"Mother", 1879 - 1937 (d. Feb. 14, 1937 in Detroit)
SACKETT	Ransom Harry	"Father", 1876 - 1952 (d. July 18, 1952 in York Twp, Washtenaw Co., MI)

Row 2

SACKETT	Mary L. BEQUERET	"Mother", 1910 - ? (d. July 26, 1986 in Ypsilanti, Washtenaw Co., MI)
SACKETT	Harry Garfield	"Father", 1916 - 1960 (d. Jan. 21, 1960 in Detroit)

Lot 17

MOE	William R.	1856 - ? (d. Dec. 15, 1931 in Jackson, MI)
MOE	Hattie ALLEN	"His Wife, Mother", 1858 - 1921 (d. Sept. 9, 1921 in Northfield Twp, Washtenaw Co., MI)
MOE	Nora WOODMANSEE	1882 - 1952 (d. Apr. 2, 1952 in Northville)
MOE	Hebert	1886 - 1964 (d. May 12, 1964 in Oakland Co., MI)
GERRARD	Douglas Ralph	MSgt U.S. Air Force, Korea, "Husband, Father", May 25, 1935 - Feb. 20, 1998 (d. in Livingston Co., MI)

Lot 16

HALL	Lon O.	Mich. Pvt. 139 Inf. 35 Div. WW I, Apr. 19, 1891 - Jan. 16, 1951 (d. Allen Park, Wayne Co., MI)
HALL	James Martin	"Father", 1855 - 19? (d. Apr. 13, 1949 in Webster Groves, St. Louis Co., MO; per DC, buried in "Northville Cem.")
HALL	Alice L. TUBBS	"Mother", 1858 - 1939 (d. June 13, 1939 in Northville)
HALL	Frank N.	Co. D., H.Q.B.N., G.H.Q. Grand Rapids, MI, Chaumont France, 1893 - 1918 (d. Apr. 26, 1918 in France)

Lot 13

No Markers

Lot 12

Row 1

BROWN	Beecher V.	1906 - 1964 (d. Apr. 29, 1964 in Flint, MI)
BROWN	Minia L. WARE	"Mother", 1881 - 1936 (d. May 3, 1936 in Northville)
BROWN	Ellen LaBASS	No Marker (d. Apr. 27, 1976 in Pontiac, Oakland Co., MI at age 73)

Row 2

BROWN	Forrest Jay	Mich. Pvt. Army Air Forces, WW II, Jan. 29, 1904 - Nov. 19, 1960 (d. in Northville)
COX	Carrie E. BROWN	1913 - 1945 (d. Apr. 21, 1945 in Indianapolis, IN)

Lot 9

WATTS	Harry Joe.	1902 - 1922 (d. Apr. 3, 1922 in Northville)
WATTS	Gracie P. WOOD	1872 - 1936 (d. July 8, 1936 in Northville)
WATTS	James B.	1861 - 1938 (d. Dec. 21, 1938 in Livonia Twp, Wayne Co., MI)
MILLER	Marian WATTS	1895 - 1921 (d. Jan. 17, 1921 in Brownwood, Brown Co., TX)

Section 10

Lot 8 East

SCHRADER infant "Infant Daughter of Nelson & Diane", Mar. 3, 1967

Lot 8 West

SALEY Dick *Harold* Mich. Pvt. STU Army TNG Corps. WW I, Dec. 8, 1891 - Feb. 28, 1950
(d. in Northville)

SALEY Phyllis *SHAFER* Aug. 8, 1896 - June 3, 1956 (d. in Northville)

Lot 5

Row 1

GRINNELL Frances B. *FLOYED* 1862 - 1920 (d. May 4, 1920 in Northville)
GRINNELL George 1862 - 1929 (d. Dec. 16, 1929 in Northville)
GRINNELL Gladys M. *HUCK* 1880 - 1972 (d. Apr. 16, 1972 in Livonia, Wayne Co., MI)

Row 2

MILNE Carrie *GRINNELL* 1882 - 1935 (d. Feb. 21, 1935 in Farmington, Oakland Co., MI)
MILNE George 1874 - 1954 (d. Sept. 22, 1955 in Livonia, Wayne Co., MI)

Lot 4

Row 1

AVEY Howard 1902 - 1920 (d. Feb. 9, 1920 in Pontiac, Oakland Co., MI)
AVEY Walter 1867 - 1923 (d. June 15, 1923 in Farmington Twp, Oakland Co., MI)
AVEY Dalton 1900 - 1934 (d. Aug. 7, 1934 in Northville)

Row 2

AVEY Baby boy 1929 (d. July 30, 1929 in Northville)
SIMMONS Isabelle AVEY (*nee*
CHATFIELD) 1881 - 1979 (d. Aug. 31, 1979 in Largo, Pinellas Co., FL; 1st husband
Walter AVEY)
SIMMONS Guy Arthur 1882 - 1961 (d. Oct. 10, 1961 in Ann Arbor, MI)

Lot 2 North

PALMER Lee M. "Son", 1896 - 1945 (d. Apr. 22, 1945 in Eloise, Wayne Co., MI)
PALMER Caddie E. *VOGT* "His Wife, Mother", 1863 - 1940 (d. Aug. 21, 1940 in Northville)
PALMER James B. "Father", 1868 - 1920 (d. July 24, 1920 in Northville)

Lot 1

No Markers

Lot 3

Row 1

MILLER Charles R. 1950 - 1998 (d. Oct. 1, 1998)
MILLER Barbara J. 1950 - 2007 (d. July 22, 2007)
UNGER Jack G. 1925 - 1980 (d. June 7, 1980 in Plymouth)
UNGER Jean C. *MATTHEWS* 1927 - 2016 (d. Jan. 31, 2016 in Plymouth)

Row 2

MATTHEWS Martha E. *HEINTZ* 1901 - 1978 (d. Aug. 9, 1978 in Ann Arbor, MI)
MATTHEWS William M. 1894 - 1959 (d. Oct. 8, 1959 in Washtenaw Co., MI)
SMITH Gertrude *SMITH* "Mother", 1875 - 1920 (d. Oct. 20, 1920 in Detroit; 1st husband William
MATTHEWS Sr.) (Stone under shrub)

Section 10

Lot 3 (continued)

Row 3

VERESH	Edward	Nov. 25, 1929 - Aug. 1, 2016
VERESH	Irene <i>Gertrude</i> MATTHEWS	July 22, 1933 - Oct. 8, 2019 (d. <u>July 21</u> , 2019)
VERESH	Karen	Sept. 12, 1956 - May 21, 2018

buried elsewhere in lot:

ALLEN	Elizabeth Jane MATTHEWS	No Marker (d. Oct. 15, 2004 at age 84)
-------	----------------------------	----------------------------------------

Lot 6

NEAL	Hulda <i>Rachel</i> LIDGARD	"Sister", 1888 - 1955 (d. May 28, <u>1954</u> in Detroit)
NEIL	Elizabeth Sharon	No Marker (d. Nov. 20, 1949 in Northville at age 6)
NEIL	Fredrick Howard	No Marker (d. July 8, 1922 in Northville at age 18)

Lot 7 West

CULP	Henry A.	Oct. 28, 1857 - Apr. 1, 1922 (d. in Northville)
------	----------	-------------------------------------------------

Lot 7 East

Row 1

VRADENBURG	Russell Ray	Dec. 23, 1902 - Nov. 10, 1979 (d. in Howell, Livingston Co., MI)
VRADENBURG	Emma <i>LaPEARL</i>	1887 - 1977 (d. Dec. 3, 1977 in Broward Co., FL)
VRADENBURG	Ray	1877 - 1959 (d. Oct. 18, 1959 in Oakland Co., MI)

Row 2

LaPEARL	Anthony	1853 - 1929 (d. Oct. 8, 1929 in Detroit)
LaPEARL	Arkie <i>CAMPAU</i>	1863 - 1937 (d. Dec. 22, 1937 in Lyon Twp, Oakland Co., MI)

Lot 10

Row 1

HINMAN	Walter M.	1905 - 1964 (d. Feb. 3, 1964 in Ann Arbor, MI)
HINMAN	<i>Kathryn Marie BURGE</i>	"w/o Walter", d. 1988 (d. Jan. 24, 1988 in Ypsilanti, Washtenaw Co., MI at age 92)
BRADLEY	Bert C.	No Marker (d. June 26, 1949 in Royal Oak, Oakland Co., MI at age 78)

Row 2

HINMAN	Harry	No Marker (d. Mar. 26, 1926 in Northville at age 15)
HINMAN	Edna M. <i>MORGAN</i>	"w/o Chas.", 1877 - 1922 (d. Nov. 25, 1922 in Detroit)
HINMAN	Charles Nelson	No Marker (d. Mar. 26, 1935 in Northville at age 59)
HINMAN	<i>Maylon Charles</i>	1907 - 1962 (d. May 9, 1962 in Macomb Co., MI)
HINMAN	Clyde N.	1913 - 1989 (d. Oct. 8, 1989 in Northville)
HINMAN	Helen <i>Elmira SCHATZ</i>	1911 - 1994 (d. Aug. 17, 1994 in Northville)

Lot 11

Row 1

SESSIONS	Jeremiah	1847 - 1925 (d. Mar. 18, 1925 in Northville)
HORSFALL	Lillian	1927 - 1937 (d. Sept. 3, 1937 in Plymouth)
CAMPBELL	Jeffery E.	1961 - 1973 (d. May 10, 1973 in Pontiac, Oakland Co., MI)
HORSFALL	Clair B.	1899 - 1976 (d. Mar. 1, 1976 in Cadillac, Wexford Co., MI)
HORSFALL	Hazel L. <i>SESSIONS</i>	1908 - 1991 (d. Jan. 27, 1991 in Grayling, Crawford Co., MI)

Section 10

Lot 11 (continued)

Row 2

SESSIONS	Albert J.	1884 - 1975 (d. Nov. 15, <u>1974</u> In Howell, Livingston Co., MI)
SESSIONS	Lillie E. <i>BRASSOW</i>	1888 - 1922 (d. Dec. 11, 1922 in Salem Twp, Washtenaw Co., MI)
CAMPBELL	James L.	1936 - 1988 (d. Mar. 9, 1988 in Lyon Twp, Oakland Co., MI)
CAMPBELL	Mabel L. <i>SESSIONS</i>	"Mother", 1907 - 1997 (d. Sept. 19, 1997 in Midland, Midland Co., MI)
CAMPBELL	Frederick A.	1929 - 1989 (d. Aug. 10, 1989 in Howell, Livingston Co., MI)

Lot 14

No Markers

Lot 15

No Markers

Lot 18

No Markers